

CW-066型高压数字温度传感器

CW-066 High Voltage Digital Temperature Sensor

1.工作原理

传感器采用铂薄膜热敏电阻器 (Pt1000) 为感温元件，探头体积5mm × 3mm × 2 mm。测量端裸露于大气中，其热敏电阻阻值随着温度变化而变化，通过高压导线传送到显示器，进行温度的直接测量。

2.特点

具有体积小、绝缘性能好、耐高电压、实际应用性强、抗干扰性能强、使用方便等特点。

3.适用标准

《cw-DZ-5004型高压数字温度传感器技术条件》

外形结构尺寸

传感器探头外形及安装尺寸见图1。

显示器外形尺寸见图2。

电气连接方式见图3。

1.Working Principle

Sensor adopts platinum film (Pt1000) as the temperature sensing element, volume of probe is 5 mm * 3 mm * 2 mm.. Measured end is expose in the atmosphere, the thermistor resistance value changes with temperature changes, the results is transfered to the display to measure temperature.

2. Characteristic

Small volume, good insulation properties, high resistance to voltage, strong practical applications, strong anti-jamming performance, easy to use, etc

Application

3.Standards

《cw - DZ - 5004 technical conditions of high voltage digital temperature sensor》

Overall dimension

Figure1. Sensor probe appearance and installation dimensions



图1 探头外形尺寸
figure 1: display size



图2 显示器外形尺寸
figure 3: Overall Dimension

电气连接 Electrical Connection

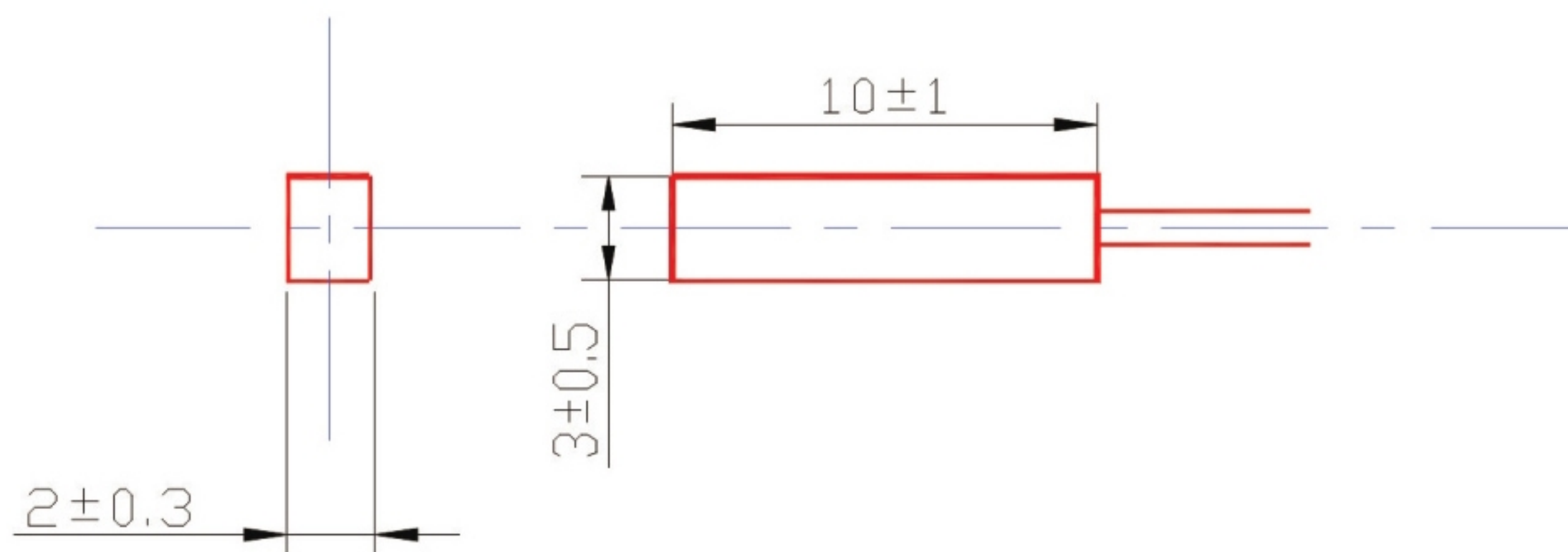
电气连接方式见图3 Figure 3. Electrical connection

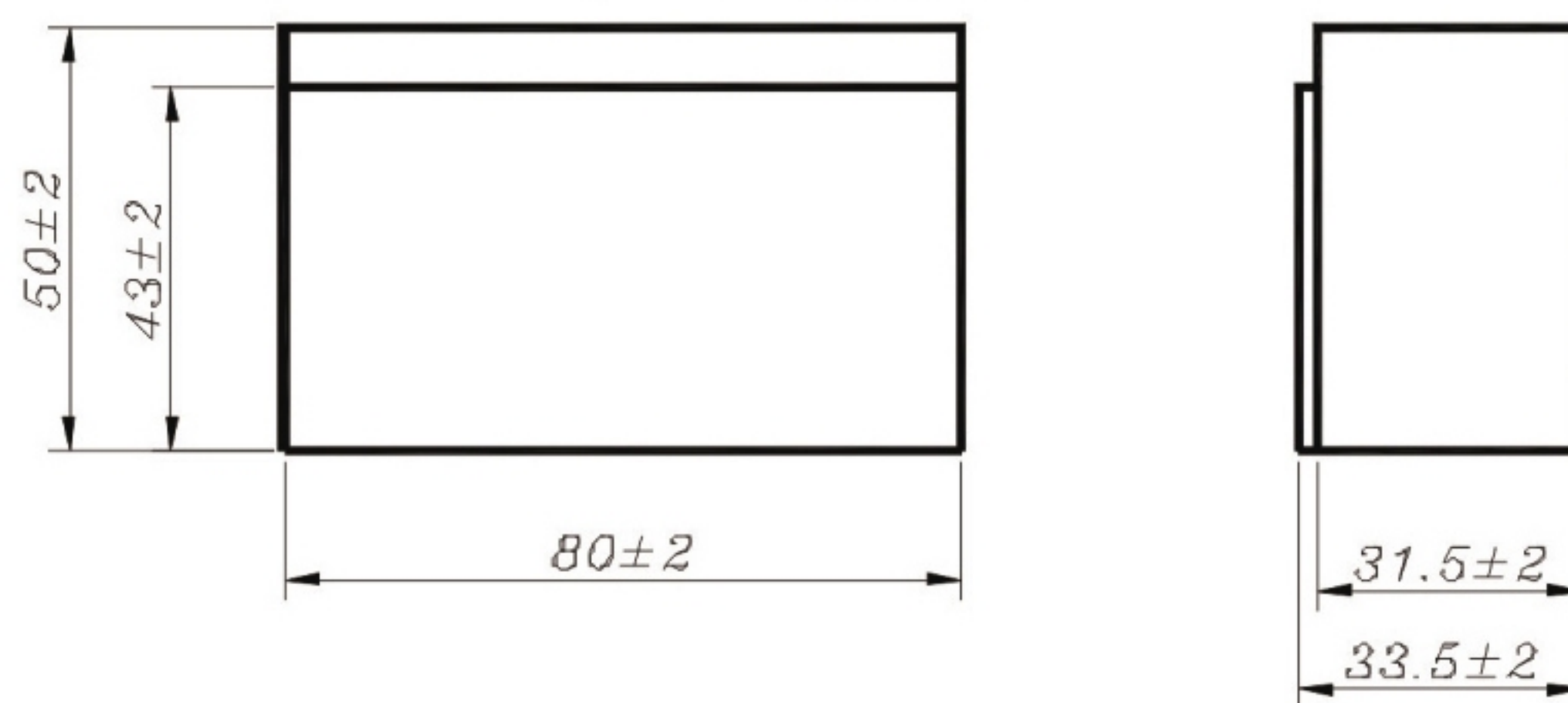
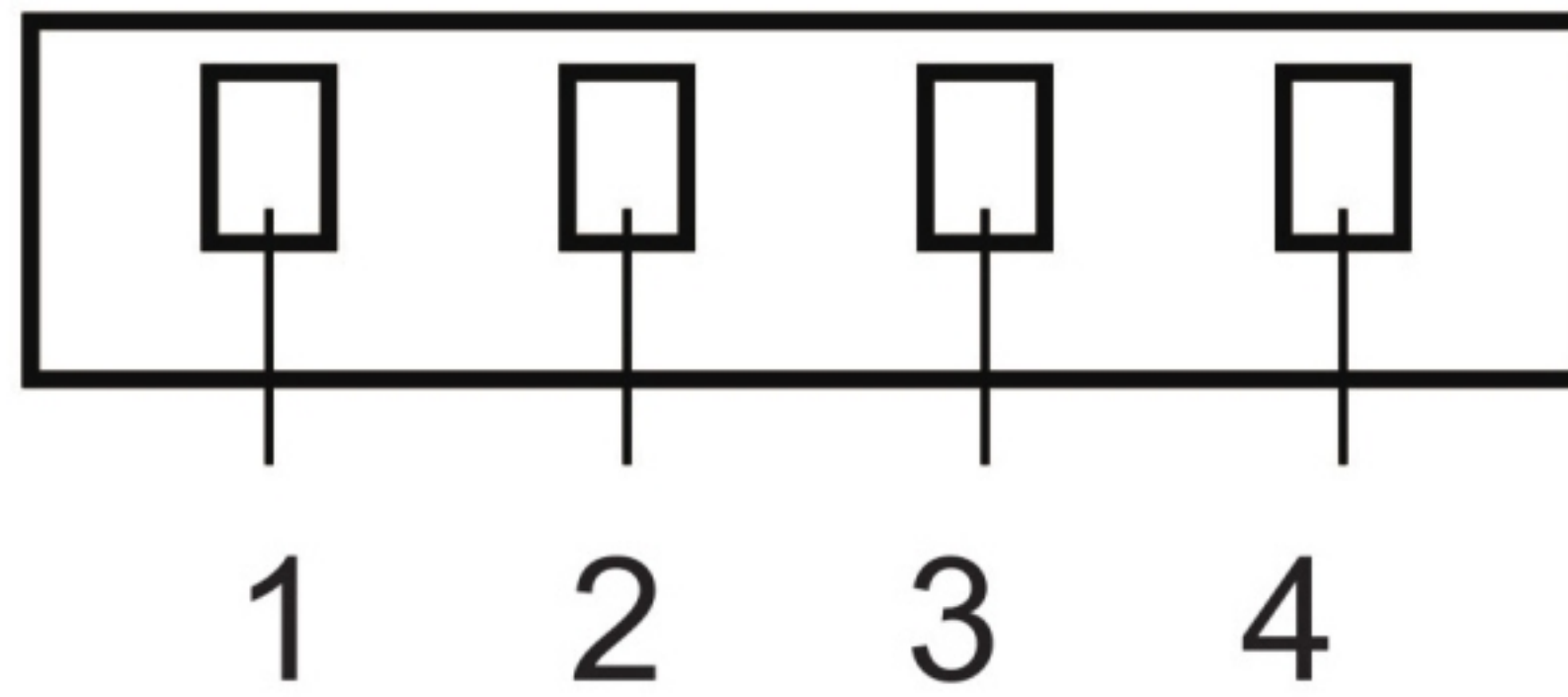

1.电源+; 2.电源-; 3.探头一端; 4.探头另一端。
1—power +; 2—power -; 3—one end of probe; 4—the other end of probe

图3 电气连接方式
Figure 3. Electrical connection

主要技术指标
Main technical parameters

名称 Name		高压数字温度传感器 High voltage digital temperature sensor
型号 Model		CW-DZ-5004型
性能特性 Performance characteristics	测量范围 Temperature Range	-55℃ ~ 150℃
	工作温度 Working Temperature	-
	激励电源 Excitation power supply	± 9 V ± 1 V DC
	重量 Weight	-
	外形尺寸 Outline Dimension	-
电气特性 Electrical characteristics	绝缘电阻 Insulation resistance	≥10,000MΩ, 500 × (1 ± 10%) VDC (探头部分) MIN..10,000MΩ, 500 × (1 ± 10%) VDC (probe)
	输出阻抗 Output impedance	-
静态特性 Static characteristics	零位输出 Zero output	-
	满量程输出 Full range output	-
	非线性 Nonlinearity	-
	重复性 Repeatability	-
	迟滞 Delaying	-
	准确度 Accuracy	≤0.5%FS
	过载 Overload	-
稳定性 Stability	零点漂移 Zero drift	-
	热零点漂移 Thermal Zero drift	-